

## 10263 & 10265 Motor & R/C kit Replacement Instructions 50017544-501 through 504 50017545-505 through 508

### Document Number

Form: 62-86-33-47

Effective: 8/06

Supersedes: None

### Summary

This kit contains a new motor or R/C kit for your 10263A/S & 10265A/S actuator.

### Kit Contents

Motor Kit					R/C Kit				
Motor 50017544 - tab	-501	-502	-503	-504	R/C 50017545 - tab	-505	-506	-507	-508
Motor, 10263A/S 120V, 50/60 Hz	X				Capacitor, 11 $\mu$ f 120V, 50/60 Hz	X	X		
Motor, 10263A/S 240V, 50/60 Hz		X			Capacitor, 3 $\mu$ f 240V, 50/60 Hz			X	X
Motor, 10265A/S 120V, 50/60 Hz			X		Resistor, 150 OHM	X			
Motor, 10265A/S 240V, 50/60 Hz				X	Resistor (2), 100 OHM		X		
Gear, 18T	X	X			Resistor, 600 OHM			X	
Gear, 12T			X	X	Resistor (2) , 400 OHM				X
Spring Pin	X	X	X	X	Gasket, Rear Cover Plate	X	X	X	X
Gasket, Gear Cover Plate	X	X	X	X	Resistor Bracket		X		X
Gasket, Rear Cover Plate	X	X	X	X	Screws (4) #4-40 x .310 lg		X		X
					Screws (4) 3/8 x 4-40		X		X

## Procedure

See Table 1 for procedure.

### **WARNING**

Disconnect power before accessing components inside the instrument.

### **ATTENTION**

When working with circuit cards always protect against electrostatic discharge by wearing a grounded wrist strap.

**Table 1 10263 / 5 Motor & R/C Installation Procedure**

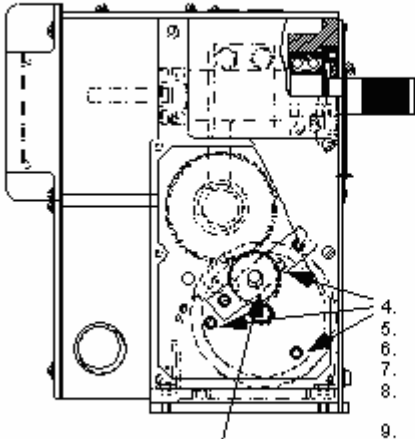
Step	Action
1	<b>Remove left side cover and lower rear cover.</b>
2	<b>Disconnect motor wiring:</b> <ul style="list-style-type: none"><li>• Remove terminal board cover and 2 screws securing terminal board.</li><li>• Remove wires from TB1-3 (white), TB1-4 (black), TB1-6 (green). (TB1 is uppermost terminal board.)</li></ul>
3	<b>Replace motor:</b> <p style="text-align: center;">10263 &amp; 10265</p>  <ol style="list-style-type: none"><li>1. Remove cover.</li><li>2. Remove retaining ring from center of gear.</li><li>3. Remove gear.</li><li>4. Remove four motor screws.</li><li>5. Remove motor.</li><li>6. Install new motor.</li><li>7. Feed motor wires through hole in wall.</li><li>8. Use general purpose RTV to seal hole around wires.</li><li>9. Reinstall gear and retaining ring.</li><li>10. Replace cover.</li></ol> <p style="text-align: center;">Figure 1 Motor Replacement</p>
4	<b>Connect motor wiring:</b> <ul style="list-style-type: none"><li>• Connect wires to TB1-3 (white), TB1-4 (black), TB1-6 (green).</li></ul>

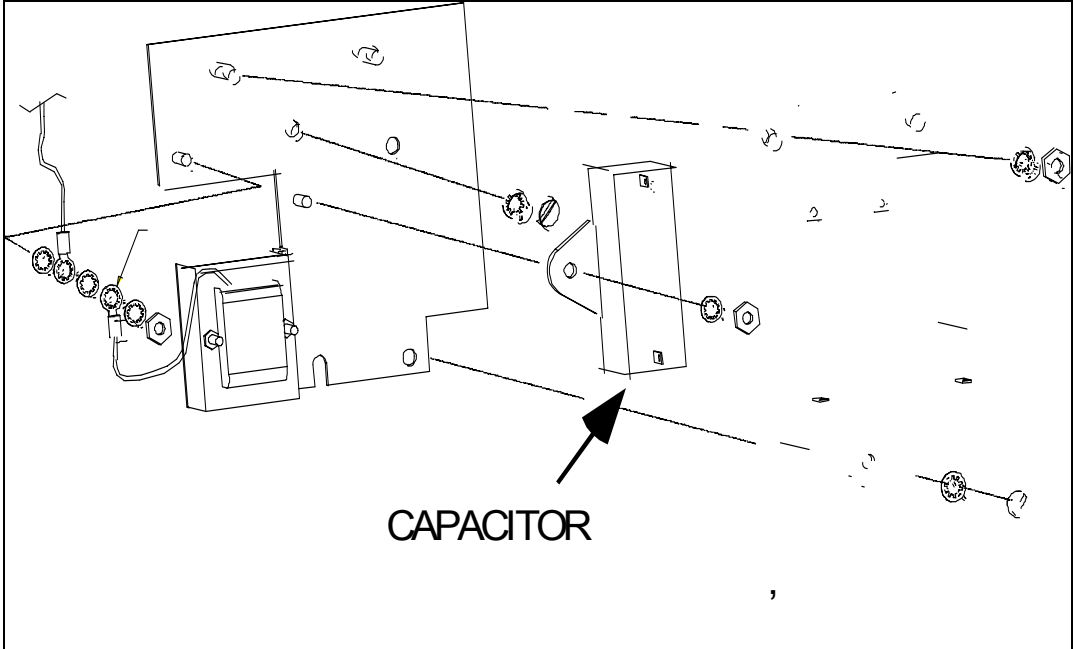
<p>5</p>	<p><b>Replace and rewire capacitors, if applicable:</b></p> <p>Capacitors are mounted behind the terminal board plate. See Figure 2.</p> <ul style="list-style-type: none"> <li>Units 10263 &amp; 10265, 120V: 60 Hz: use 11<math>\mu</math>f capacitor. 50 Hz: use 11<math>\mu</math>f capacitor.</li> <li>Units 10263 &amp; 10265, 240V: 60 Hz: use 3<math>\mu</math>f capacitor. 50 Hz: use 3<math>\mu</math>f capacitor.</li> </ul>  <p style="text-align: center;"><b>Figure 2 Location of capacitors</b></p>
<p>6</p>	<p><b>Reinstall terminal board with 2 screws.</b></p>
<p>7</p>	<p><b>Replace and rewire resistors, if applicable:</b></p> <p>Resistors are mounted on the casting body as shown. Use bracket plate if the frequency is 50 Hz to mount additional resistor in series with other two resistors. See Figure 3.</p> <ul style="list-style-type: none"> <li>Units 10263 &amp; 10265, 120V: 60 Hz: use 150 Ohms resistor 50 Hz: use 100 Ohms resistor X 2 sets.</li> <li>Units 10263 &amp; 10265, 240V: 60 Hz: use 600 Ohms resistor 50 Hz: use 400 Ohms resistor X 2 sets</li> </ul>

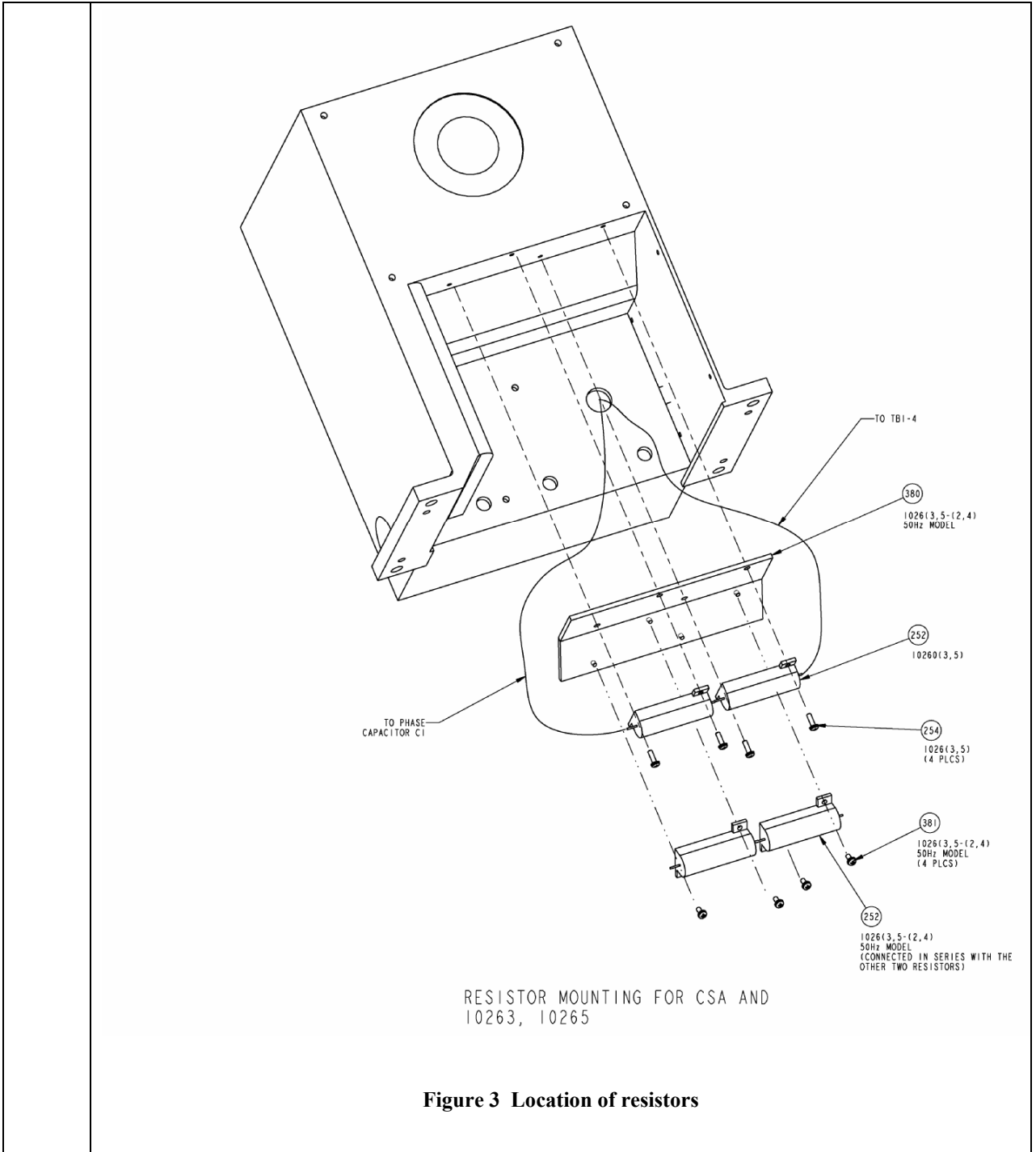

8	<p><b>Check motor operation:</b></p> <p>Connect power and check motor for proper operation. If necessary, rewire to correct</p>
9	<p><b>Install new gaskets and reattach covers.</b></p>